

PLAN OF PROPOSED (G+B) NINE STORIED RESIDENTIAL BUILDING OF (SHREE BUILDERS & DEVELOPERS)
 REPRESENTED BY MR. KUNTAI BHATTACHARJEE, MR. DEBARRATA ROY, SMT. SRIJA BHATTACHARJEE, SMT. CHHANDA
 MUKHERJEE, SOUMITRA MOJUMDER, ANUP MAJUMDER.
 L.R. PLOT NO - 116. R.S. PLOT NO 26/486. R.S. KHATIAN NO - 274, L.R. KHATIAN NO
 -2611, 2612, 2610, 2619, 2647, 2792,
 2786, 2785. J.L. NO - 109. MOUZA- SHANKARPUR.
 P.S.-NTPS, DIST-PASCHIM BARDHAMAN.

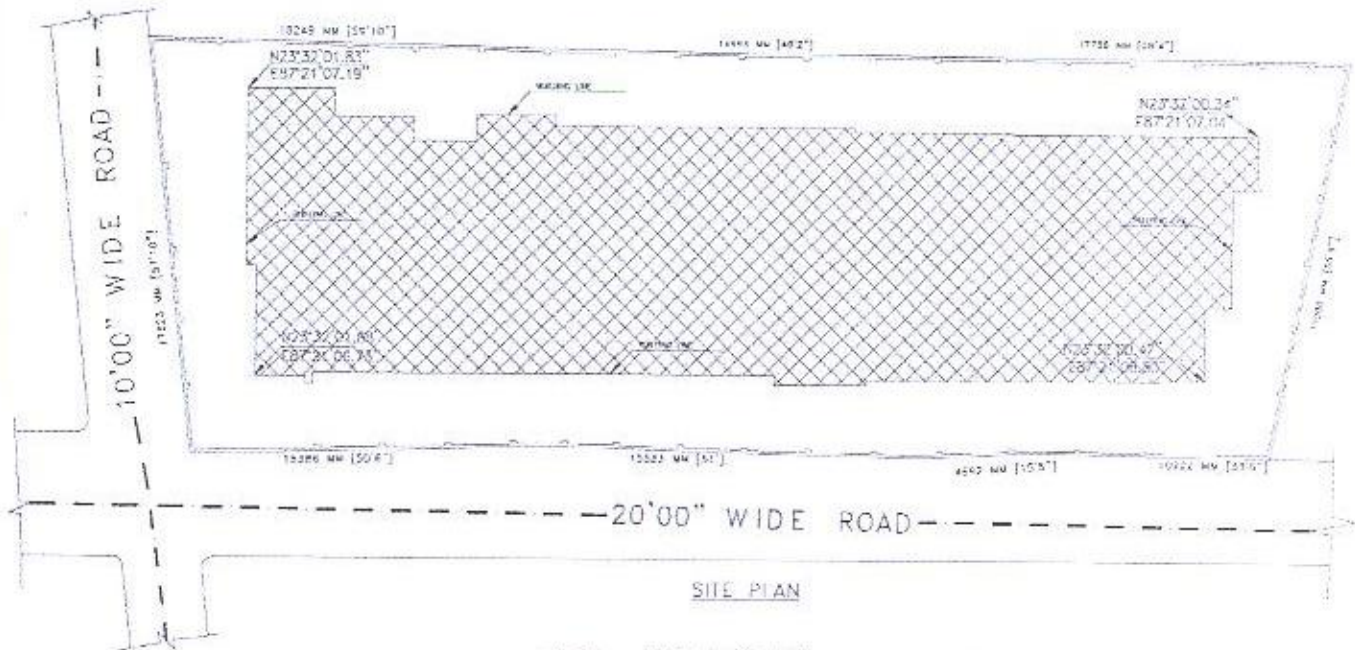

SITE PLAN

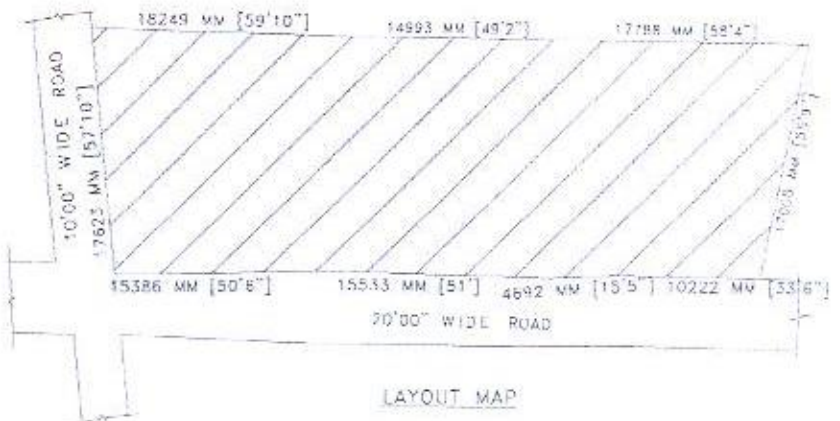

LAYOUT MAP

H. Ghosh
HIRAK GHOSH
 Consultant Civil Engineer
 Lic No. - L.B.PM/163/AMC-DMC/SPD/165
 G.I.O.S, Durgapur-16